



## 1 bed apartment to buy in SW17

Church Lane, London, SW17 9PU

**£190,000** Starting Bid

 x1  x1  x1

Tenure

**Leasehold**

Off Street parking

## Property features

- ✓ Being Sold via Secure Sale online bidding. Terms and Conditions
- ✓ One bedroom flat
- ✓ Close to Tooting Bec & Broadway Stations
- ✓ EPC Rating D

## Key Information

- ✓ Council Tax: Band A
- ✓ EPC Rating: D
- ✓ Heating supply: Electric
- ✓ Electric supply: National Grid
- ✓ Water supply: Direct mains water
- ✓ Mobile signal: Good

## Description

A well-presented one-bedroom apartment.

Finished in neutral décor throughout, the apartment offers comfortable and practical living space, ideal for first-time buyers or as an investment. Ideally situated for both Tooting Bec & Tooting Broadway underground stations. The green open spaces of Tooting Bec Common are also just a short walk away, as well as all local amenities, restaurants and bars located in Tooting Broadway.

Council Tax Band: A

Tenure: Leasehold

Length of Lease: 116

Annual Service Charge Amount: £1,080.00

Price: Starting Bid £190,000

Property Type: Apartment

Parking: Off Street

Year built: 1960

Construction materials: Brick and block

Risk of floods and or erosion: No

Flooded in last 5 years: No

Flood defences: No

Planning permissions or proposals for development: No

Coalfield or mining area: No

Listed property: No

Conservation area: No

Public rights of way: No

Adaptions for accessibility: No

Restrictions: No

Required access: No

Heating: Electric

Electric: National Grid

Water: Direct mains water

Sewerage: Standard UK domestic

Air conditioning: No

Mobile signal coverage: Good

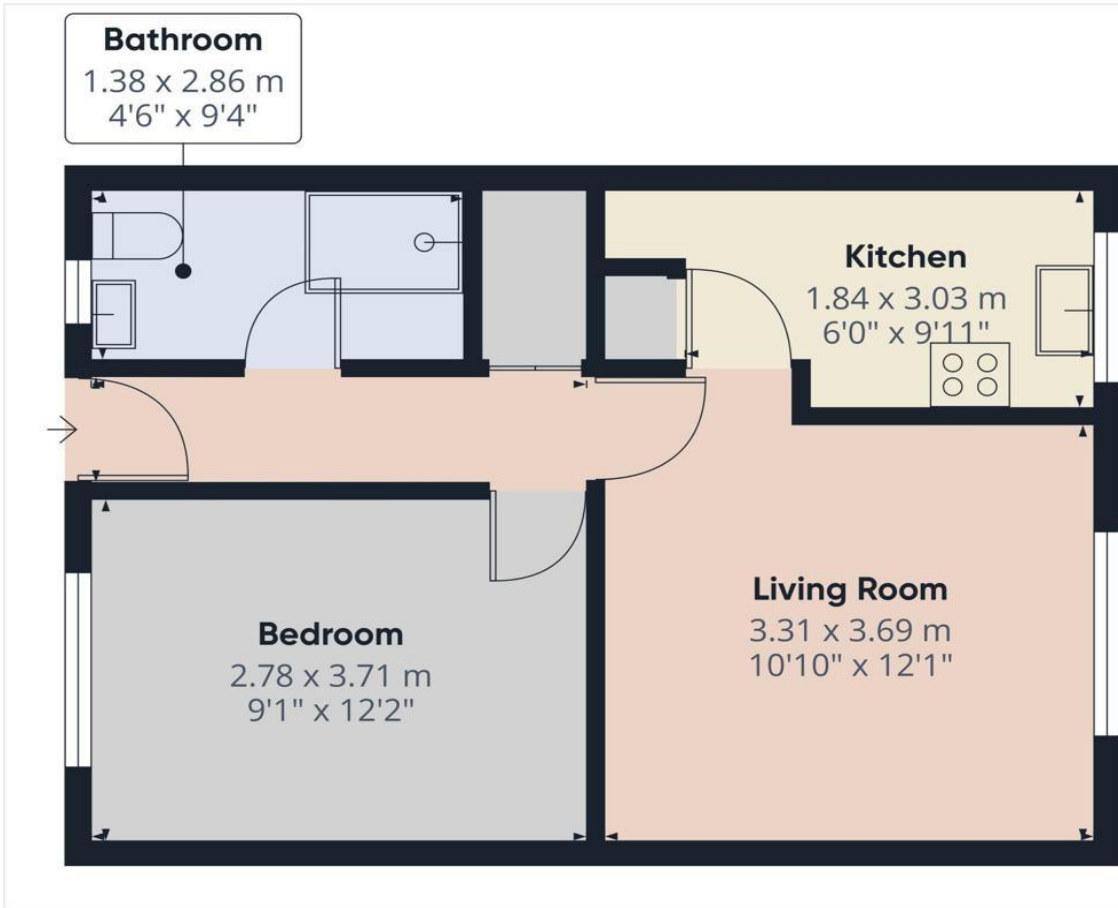

Approximate total area\*\*  
38.2 m<sup>2</sup>  
411 ft<sup>2</sup>

(1) Excluding balconies and terraces

Calculations reference the RICS IPMS 3C standard. Measurements are approximate and not to scale. This floor plan is intended for illustration only.

GIRAFFE360

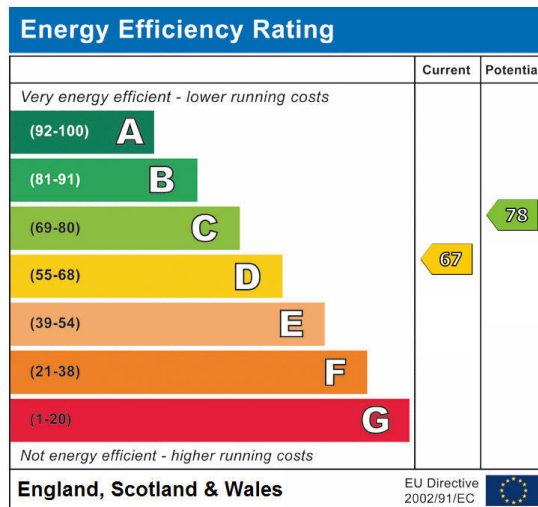

Church Lane, London, SW17 9PU

Contact your local branch today for more information on this property:

**7 Bath Road, Hounslow, Middlesex, TW5 9AX, Tel: 02085772777, <https://www.lmark.co.uk/>**

These particulars, whilst believed to be accurate are set out as a general outline only for guidance and do not constitute any part of an offer or contract. Intending purchasers should not rely on them as statements of representation of fact, but must satisfy themselves by inspection or otherwise as to their accuracy. No person in this firm's employment has the authority to make or give any representation or warranty in respect of the property.

